



VEDMAAN GROUP



दीन दयाल जन
आवास योजना



CELLULAR

SOUTH CITY - 2

Sector - 37, Jhajjar, Haryana

**SOUTH CITY
02**

PROJECT DETAILS:

Promoter: "CELLULAR" | Under License : "CELLULAR CONSULTANTS PRIVATE LIMITED"

Land: 10.68125 Acre | Number of Plots: 210 | Size of Plots: 90 to 180 Sq Yards

License Number: 98 of 2024 | HRERA Number: HRERA-PKL-JJR-637-2024 Dated 06.11.2024

Picture for reference only

ABOUT US

Group is founded by expert professionals with years of experience in Real Estate industry. Our expertise is to provide best Architectural Solutions, Across a lot of portfolios like Commercial, Residential, Retail, Hospitality and Leisure.

Our Experienced Team understands the details involve in turning your dream of owning a plot into reality with comfort, creativity and originality, **"SOUTH CITY-2"** is best example of our art and architecture with accuracy and perfection.

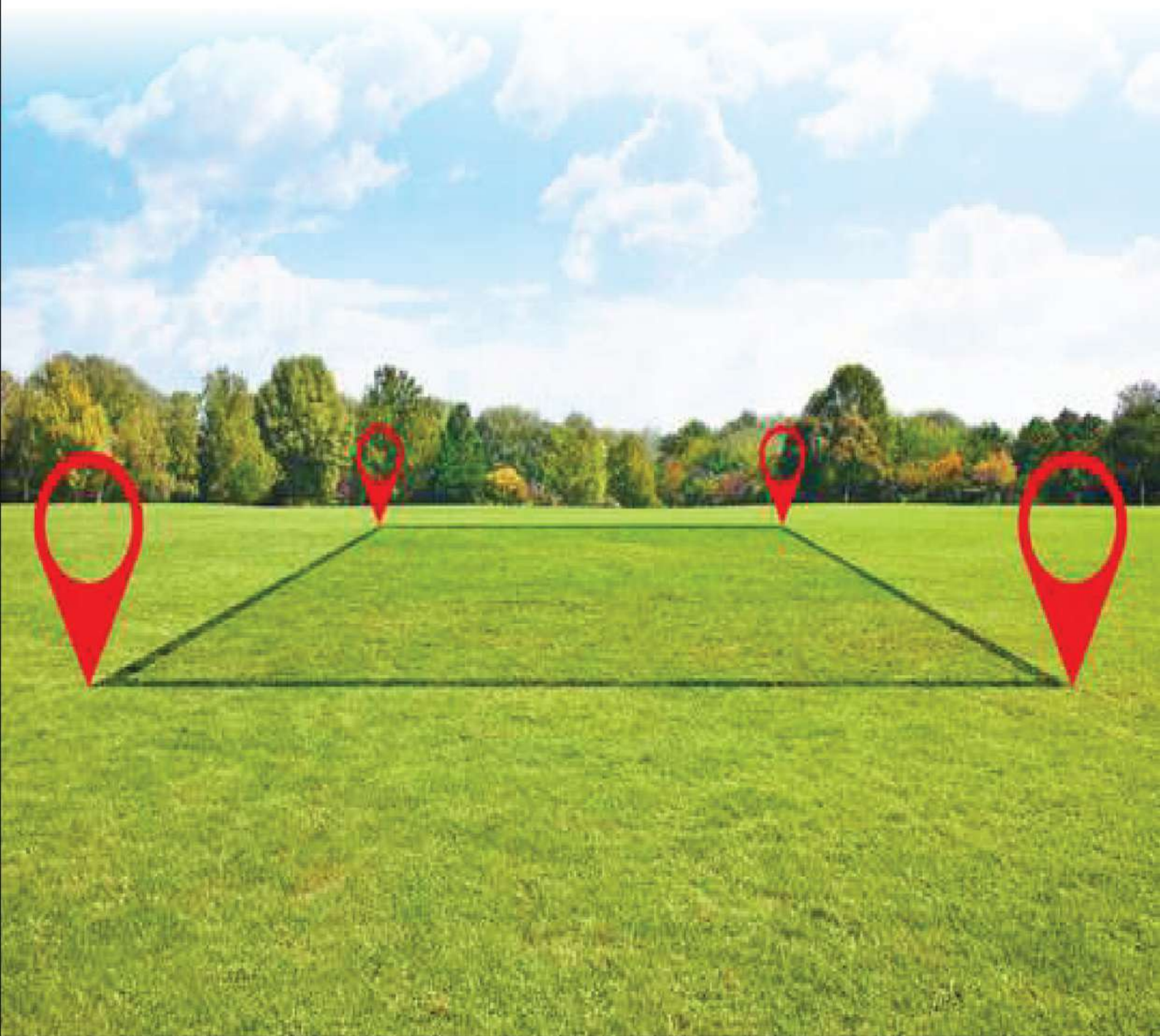

AMENITIES:



GATED COMPLEX/COMMUNITY



24x7 SECURITY



YOGA AND CENTRAL LAWN



JOGGING TRACK



KIDS PLAY AREA



COMMERCIAL SPACE



MILK AND VEGETABLE BOOTH



FRESH WATER SUPPLY



LUSH GREEN MULTIPLE POCKETS



UNDERGROUND ELECTRICITY LINES



WIDE INTERNAL ROADS

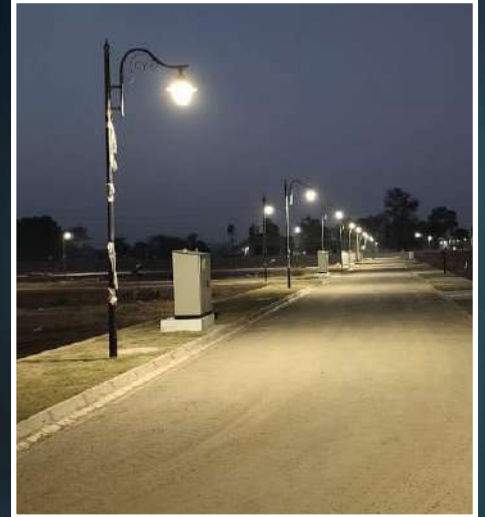



Walking Distance from Pratapgarh Farms

CONNECTIVITY:

SOUTH CITY-2 a gated affordable plotted colony under Deen Dayal Jan Awas Yojna, granted license no. 82 of 2023 issued by D.T.C.P. Chandigarh, Haryana, is strategically placed in Sector - 37, Jhajjar and well connected to State & National Highways.

It is also near to “Pratapgarh Farms”, Jhajjar and has direct connectivity to:

- 2-5 mins from NH-71 Rewari Rohtak Highway
- 2-5 mins from Jhajjar City
- 2-5 mins from Jhajjar Railway Station
- 2-5 mins from Jhajjar Bus stand
- 10-15 mins from Indospace Industrial Park Badli
- 10-15 mins from Reliance MET City
- 10-15 mins from Kundali – Manesar – Palwal (KMP) Expressway
- 15-20 mins from AIIMS NCI at Badsa, Jhajjar
- 20-25 mins from Sultanpur Bird Century
- 30-35 mins from Dwarka Expressway
- 40-45 mins from Gurugram, Connected with highways
- 50-55 mins from Indira Gandhi International Airport (IGI)

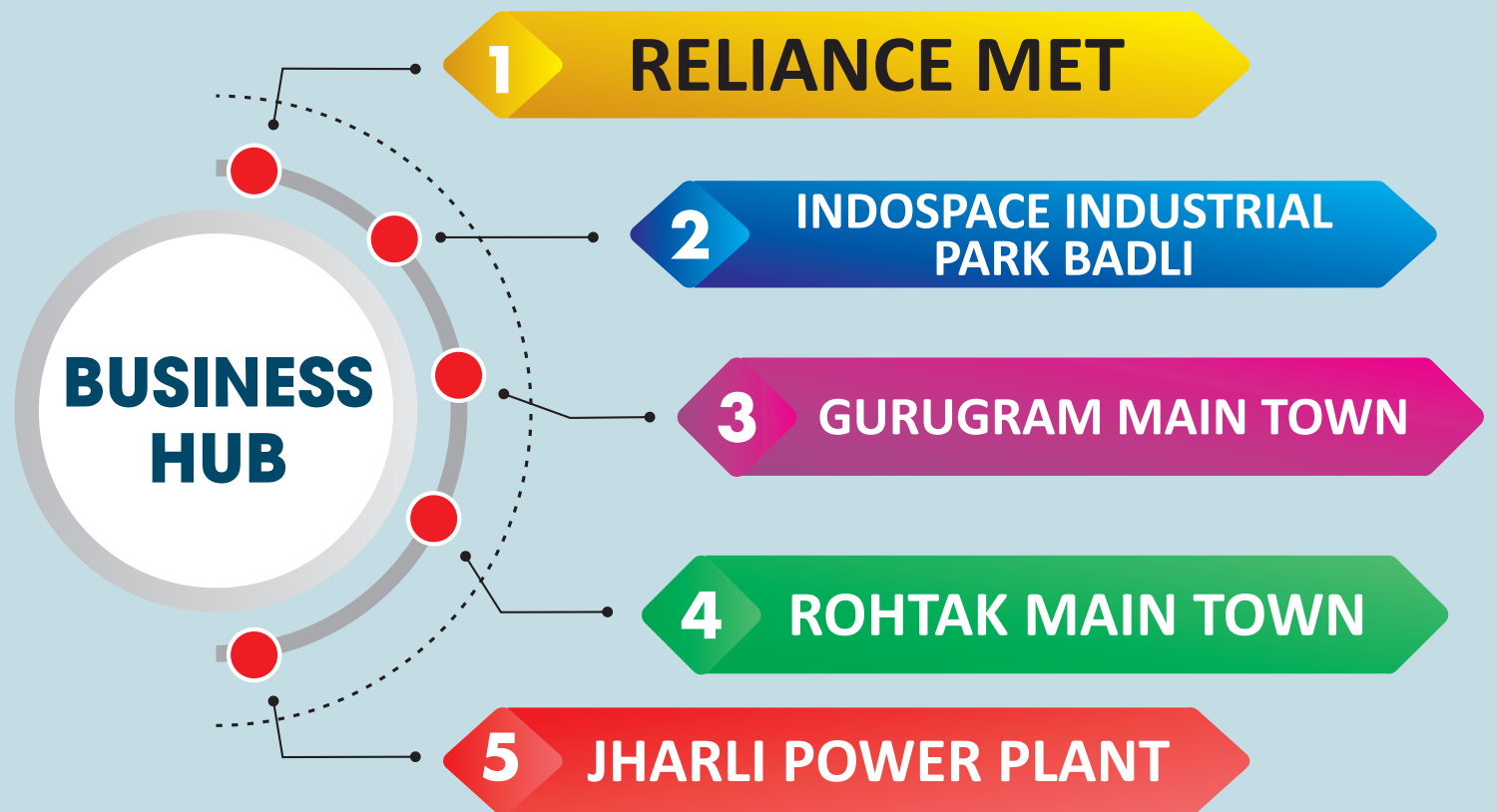

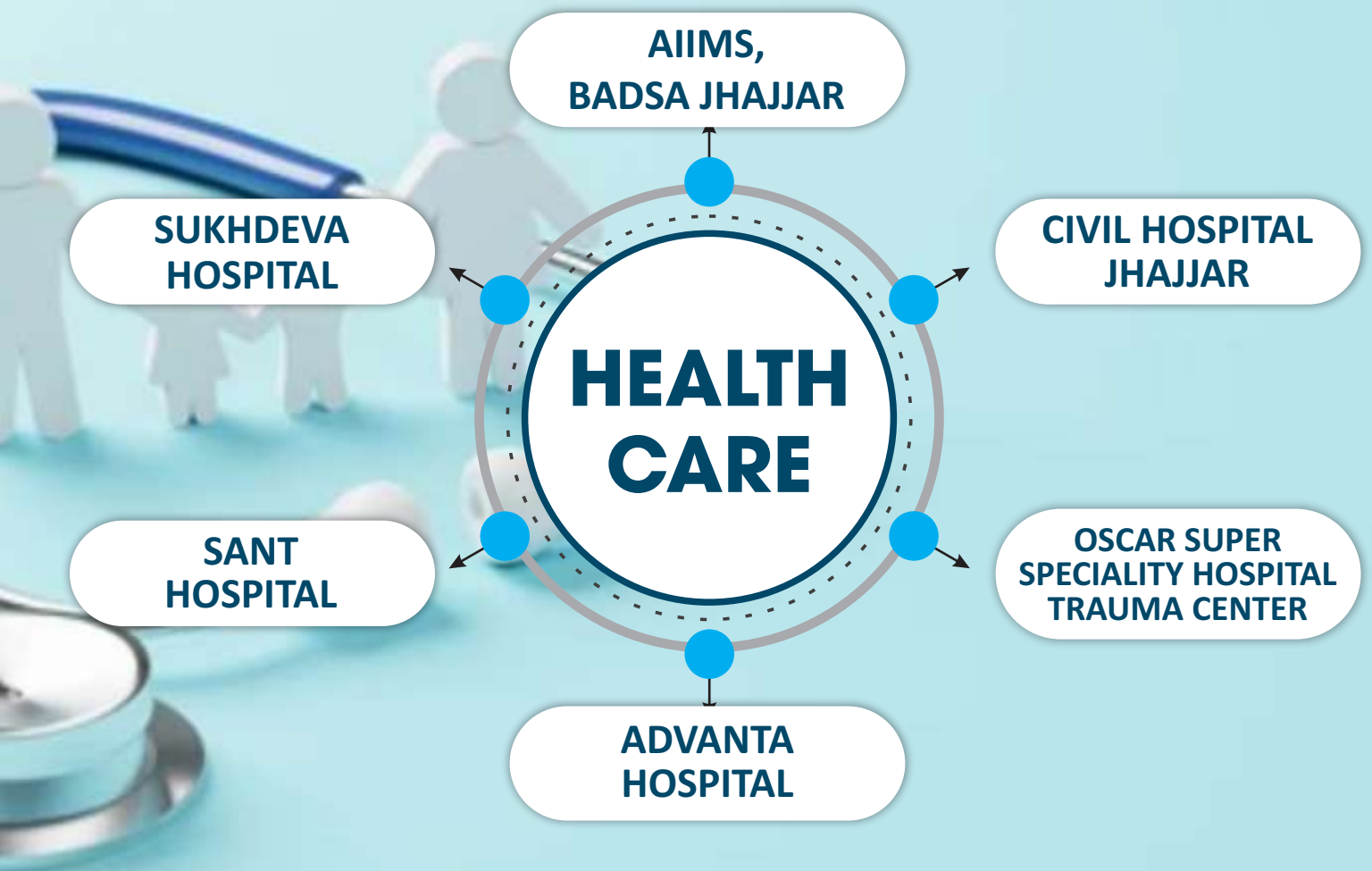

SITE PLAN

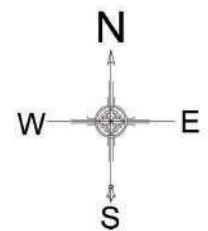
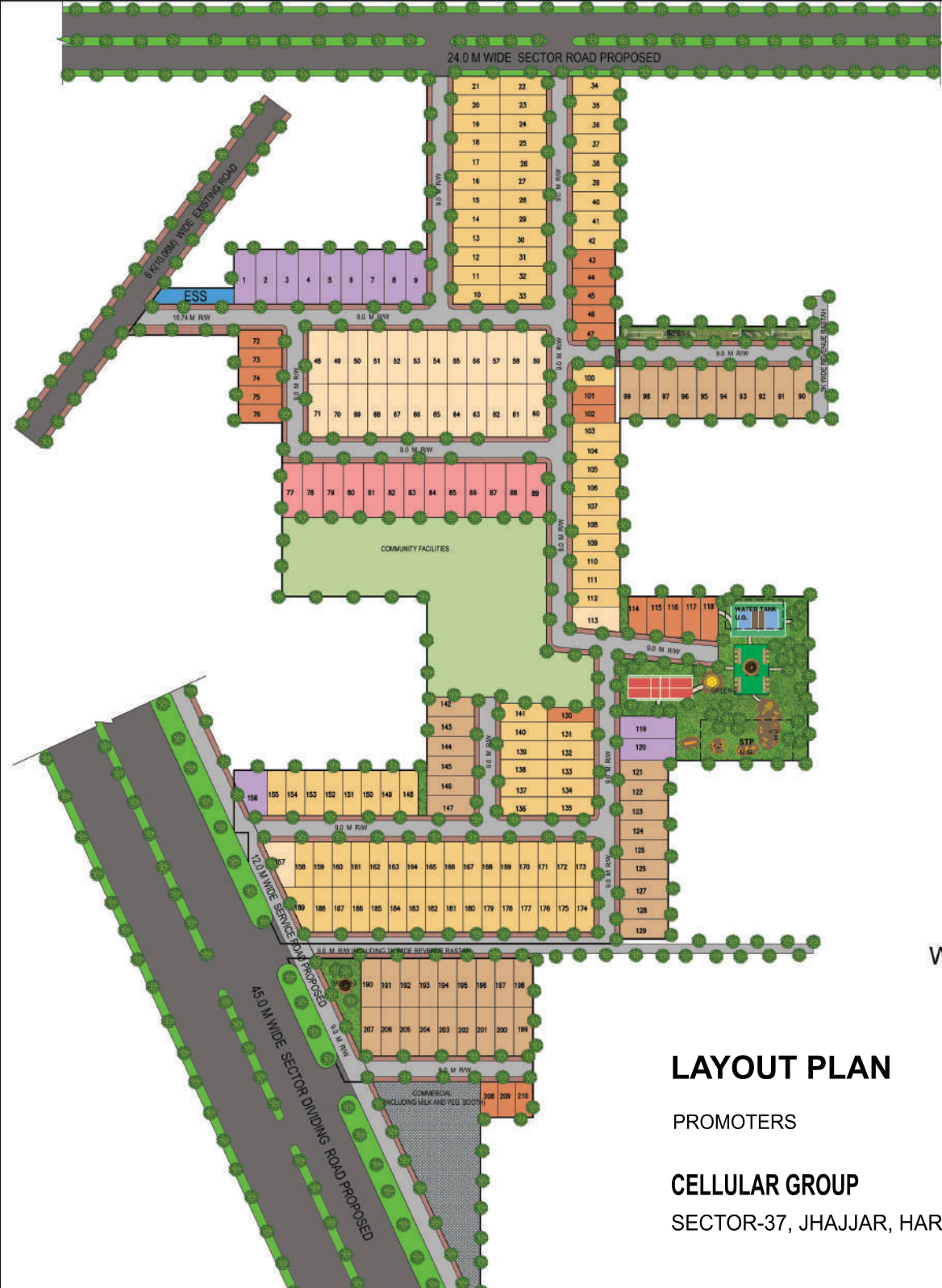

LAYOUT PLAN

PROMOTERS

CELLULAR GROUP

SECTOR-37, JHAJJAR, HARYANA



Cellular in association with Vedmaan Group

Site Office :- Plot No. 72 & 73, South City - 2,
Sector-37, Jhajjar, Haryana-124103



HRERA-PKL-JJR-637-2024